



Phone: 940-365-5833
Fax: 940-365-5834

5097 U. S. Hwy 377
Krugerville, Texas 76227

Driveway Culvert Application

Project Address:			
Lot: _____	Block: _____	Subdivision: _____	Zoning: _____

Owner Information:			
Name: _____		Contact Person: _____	
Address: _____			
Phone Number: _____	Fax Number: _____	Mobile Number: _____	

Contractor	Contact Person	Phone Number	Fax Number

Signature of Applicant: _____ Date: _____

THE CITY MUST RECEIVE THE FOLLOWING, ALONG WITH THE \$500 CULVERT APPLICATION FEE, BEFORE ANY CULVERT APPLICATIONS WILL BE REVIEWED.

- 1 One copy of a site plan which details the location of the proposed driveway culvert and design calculation indicating that the culvert is adequate to carry the 100 year frequency storm. The scale on the plan should be no smaller than one (1) inch = 50 feet.
- 2 Written specifications indicating overall dimensions of proposed culvert, including headwalls, depth and width of the drainage ditch, and the distance of the proposed installation site from the connecting roadway, together with the specification of the material to be used.
- 3 Upon approval of application, a permit for installation will be issued by the City and construction may commence.
- 4 A certified culvert certificate must be prepared and received by the Inspector before final inspection will be approved.
- 5 Driveway construction is to be approved by the Building Inspection Department under the building permit.
- 6 Culverts in highway department R.O.W. will require a copy of the approved highway department permit and a copy of the highway department application package to be submitted with application.
- 7 Denied or unapproved requests may be subject to pass through costs in excess of the \$500 standard fee.

OFFICE USE ONLY:

Approved by: _____	Date approved: _____	
---------------------------	-----------------------------	--

Paid: _____
 Check #: _____
 Date: _____

Total Fees: _____
 Issued Date: _____
 Issued By: _____

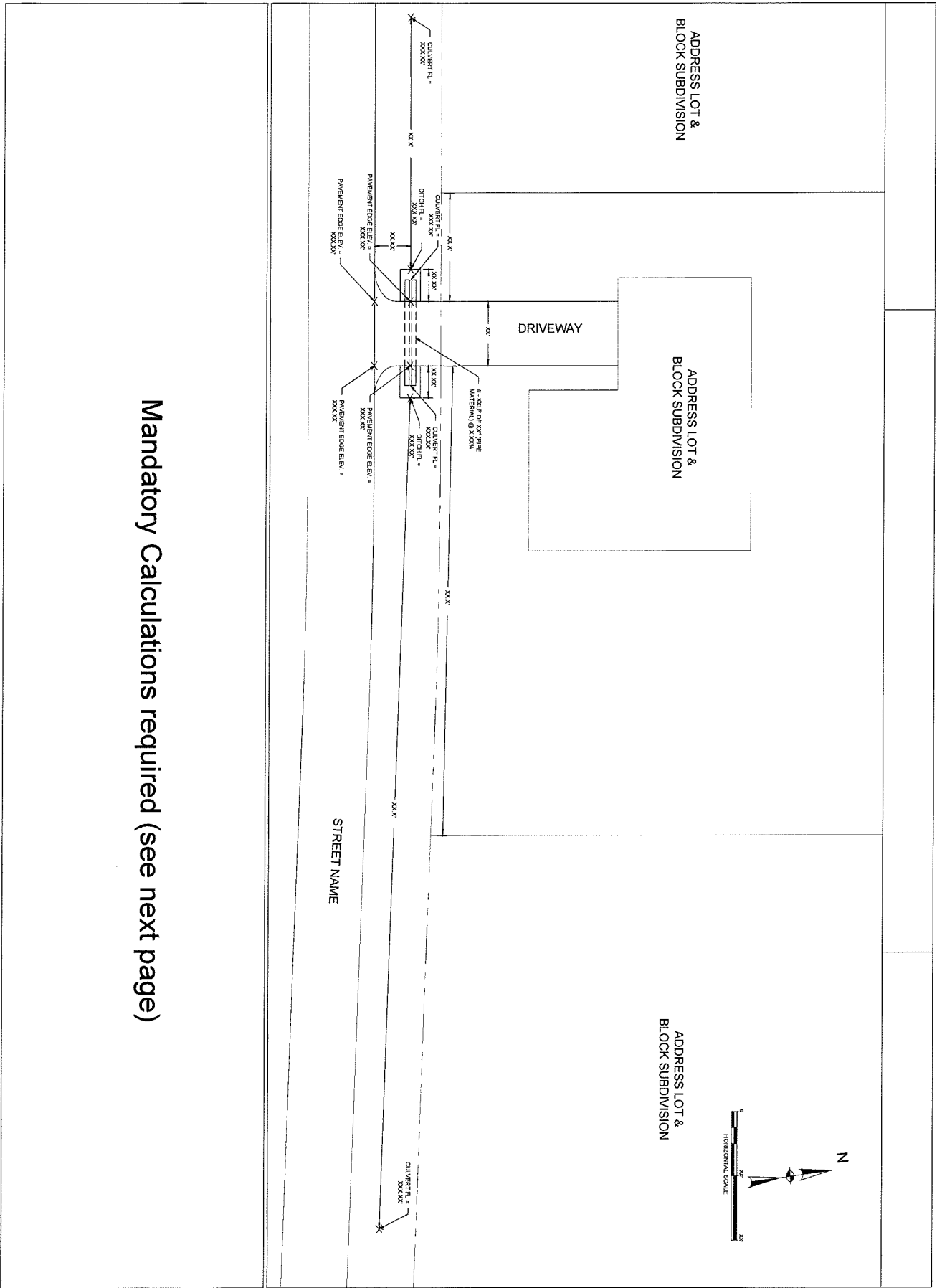

Mandatory Calculations required (see next page)

SEAL SEAL AUTHORIZATION	COMPANY INFORMATION	DRIVEWAY CULVERT DESIGN ADDRESS CITY, STATE																								
PROJECT NO. ISSUED DRAWN BY CHECKED BY SCALE SHEET TITLE SHEET NUMBER	<table border="1" style="width: 100%; border-collapse: collapse;"> <thead> <tr> <th colspan="3">REVISION</th> </tr> <tr> <th>NO</th> <th>DATE</th> <th>DESCRIPTION</th> </tr> </thead> <tbody> <tr><td> </td><td> </td><td> </td></tr> <tr><td> </td><td> </td><td> </td></tr> <tr><td> </td><td> </td><td> </td></tr> <tr><td> </td><td> </td><td> </td></tr> <tr><td> </td><td> </td><td> </td></tr> <tr><td> </td><td> </td><td> </td></tr> </tbody> </table>	REVISION			NO	DATE	DESCRIPTION																			
REVISION																										
NO	DATE	DESCRIPTION																								

Mandatory Calculations Needed for Engineering Review

Downstream Existing Culvert Flowline = _____

Distance from Proposed Culvert to Downstream Existing Culvert = _____

Upstream Existing Culvert Flowline = _____

Distance from Proposed Culvert to Upstream Existing Culvert = _____

Proposed Culvert Influent Flowline = _____

Proposed Culvert Effluent Flowline = _____

Proposed Culvert Grade = _____

Proposed Culvert Length = _____

Proposed Culvert Diameter = _____

Proposed Culvert Material = _____

Distance from Proposed Culvert to Upstream Property Line = _____

Distance from Proposed Culvert to Downstream Property Line = _____

Distance from Proposed Centerline to Edge of Street Pavement = _____

Length of Upstream Headwall = _____

Length of Downstream Headwall = _____

Elevation of the Driveway Pavement Edge Above Upstream Flowline = _____

Elevation of the Driveway Pavement Edge Above Downstream Flowline = _____

Elevation of Street Pavement Edge Perpendicular to Upstream Flowline = _____

Elevation of Street Pavement Edge Perpendicular to Downstream Flowline = _____



SAFE BUILT INSPECTION SERVICES

Permit Submittal

All completed permit documents shall be submitted to City Hall. Processing time is 7 to 10 days.

Permit Issuance

Once the permit has been approved, the requestor will be contacted by City Hall personnel and notified of fees.

Plan Review

Countywide Inspection Services will be conducting residential and commercial plan reviews. The applicant will be contacted by Countywide if additional information is needed. You may contact City Hall for the status of your permit at 940-365-5833.

Inspection Requests

Please contact Countywide Inspection Services to request inspection(s). Any of our permit technicians can assist you. Inspections shall be requested 24 hours in advance. Those inspections requested during normal business hours, will be performed the next business day.

Inspection Request Line: 940-521-0470
Email: inspections@cwistx.com

Field Inspections

Your inspectors' names are Mike Doughty (940)-284-9954 & Randy Johnson (214) 930-8677

We look forward to working with you to ensure that the community is provided with a safe and durable built environment.